



Intellihot

**THANK
YOU**

FOR YOUR ORDER

NOTICE: Seller's warranty shall be void and of no effect if:

1. Licensed contractor is not used to install products.
2. Buyer uses the products in a manner not intended by Seller or in a manner not disclosed by Buyer; or
3. The breach resulted from the actions or omissions by another party or misuse of the products. For further questions or assistance feel free to reach out to our Customer Support team at: 877-835-1705

WHAT'S IN THE KIT

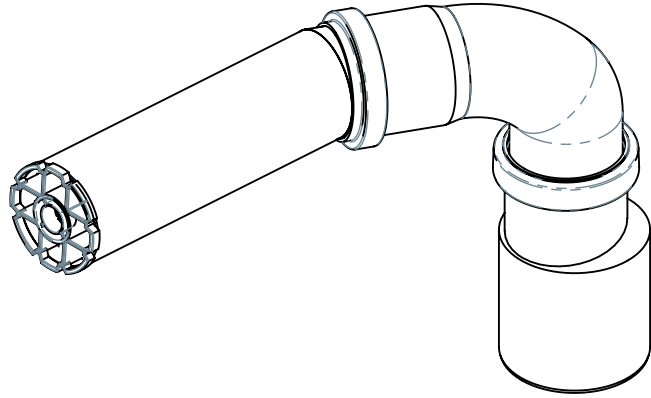

EXHAUST DUCT
(3" TO 2")-w- BIRD SCREEN
(1 INCLUDED)

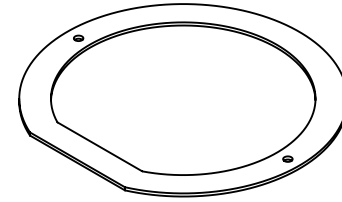

INTAKE GASKET
(1 INCLUDED)

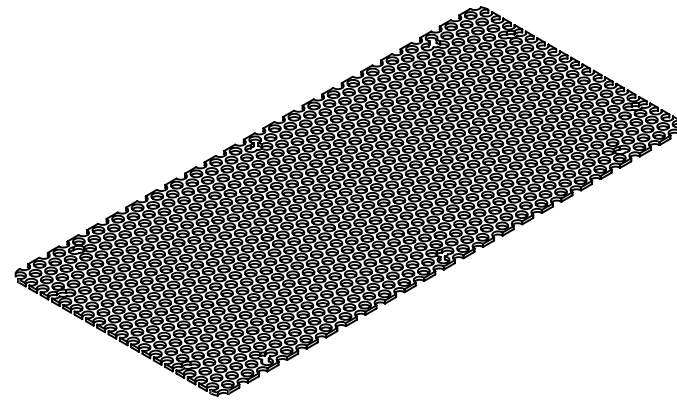

BOTTOM AIR INTAKE SCREEN
(1 INCLUDED)

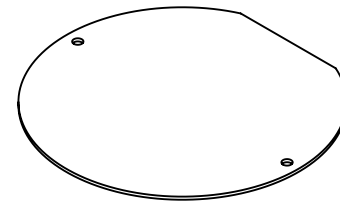

COVER PLATE
(1 INCLUDED)

EXTRA PARTS

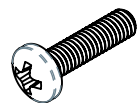

M4 x 0.7 x 16mm
SEALING SCREW
(2 INCLUDED)

PAIR WITH



#8 SEALING WASHER
(2 INCLUDED)

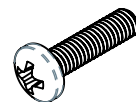

M4 x 0.7 x 16mm
STD. SCREW
(4 INCLUDED)

PAIR WITH



M4 FLAT WASHER
(4 INCLUDED)

Outdoor Kit Installation Kit #: IGT-SPR0063

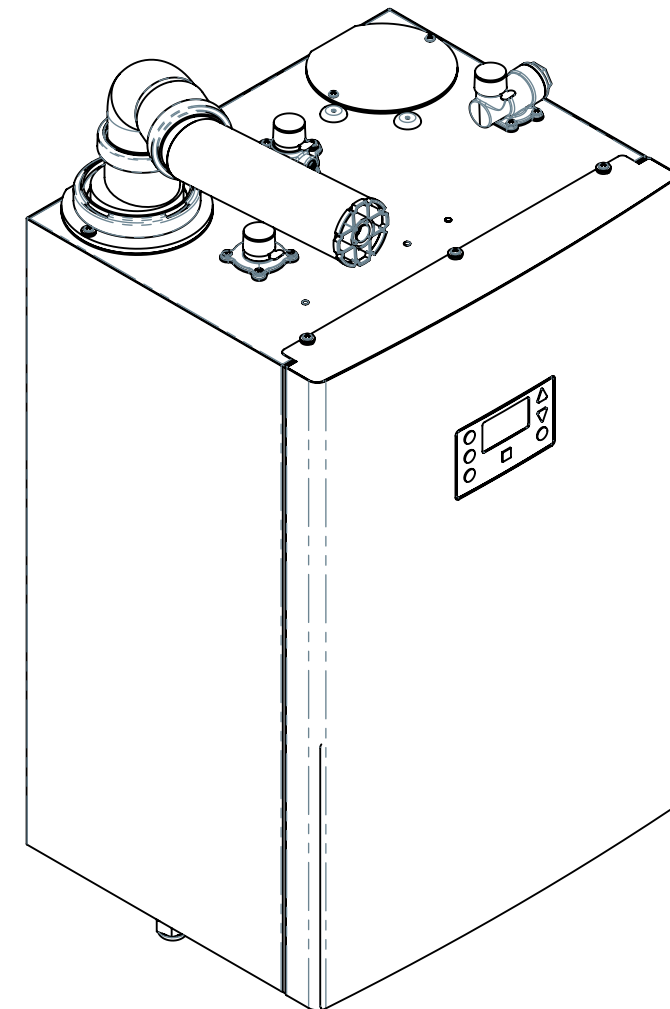

Applicable Models: i200, i250, i200P, i250P, iQ251, iQ251D

Caution: Installation Instructions should be followed precisely for proper functionality.

Note: Before beginning installation of kit, please shut off the water & gas to the heater and shut off power to the unit by unplugging from the outlet.

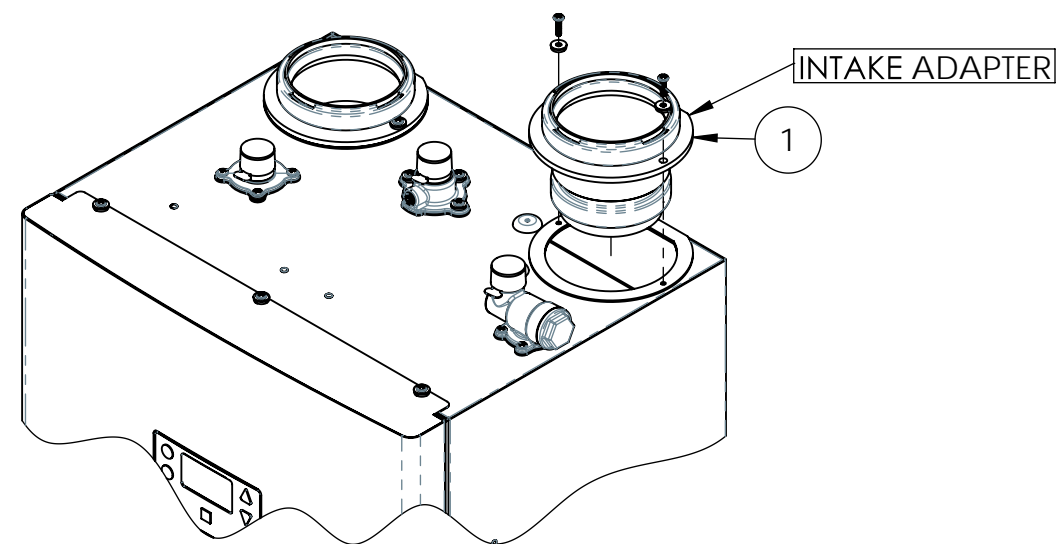

1. Remove the intake adapter by removing the (2) M4 screws & washers. Please retain this hardware.

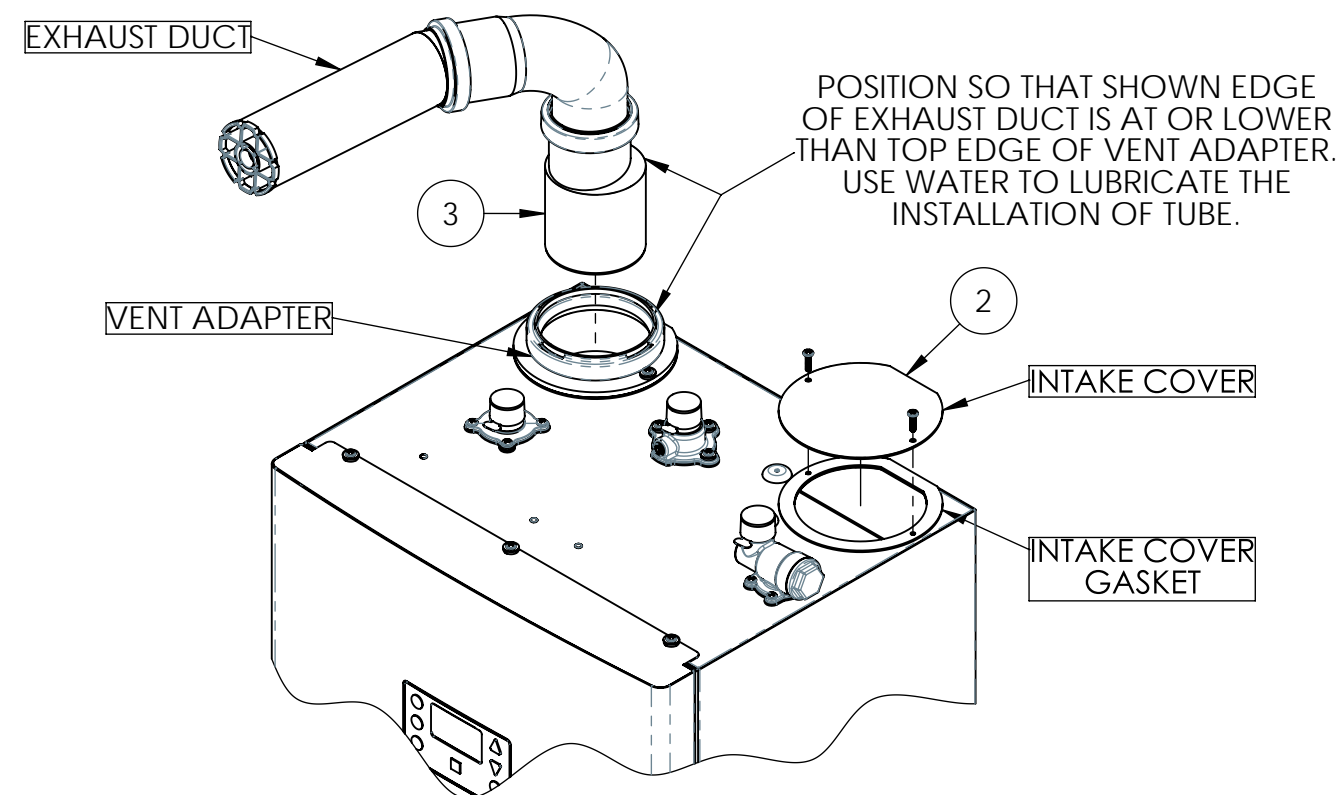

2. Install the intake cover plate and gasket using the (2) M4 x 0.7 x 16mm screws & washers.
3. Slip in the outdoor exhaust duct into the exhaust vent adapter on the top of the unit. Bottom of duct needs to be past the interior rubber seal.

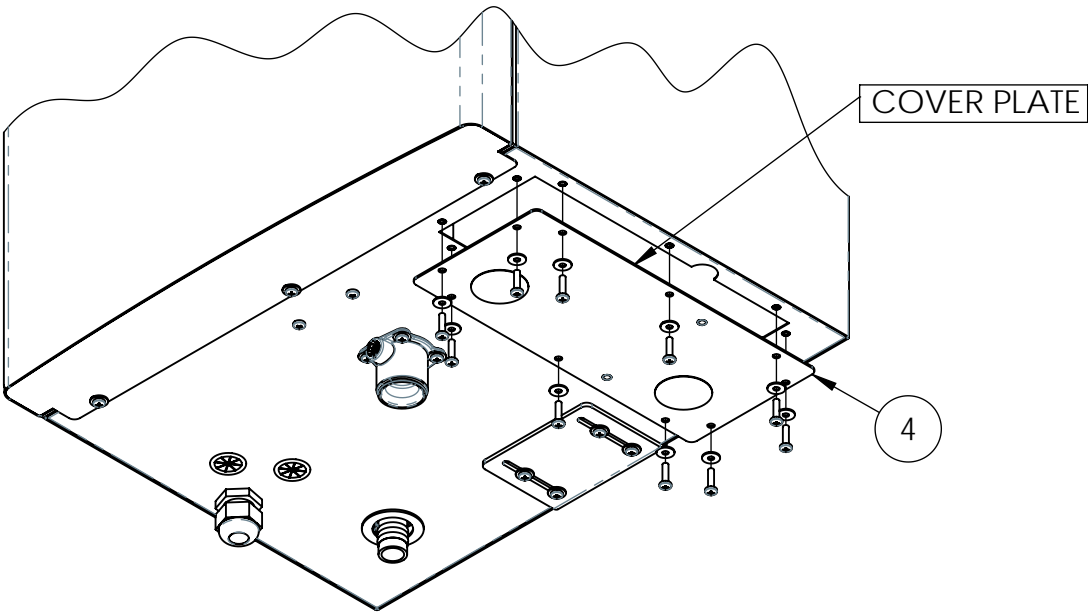

4. Remove the plate heat exchanger bottom cover plate assembly by removing the (10) M4 screws & washers. Please retain this hardware.

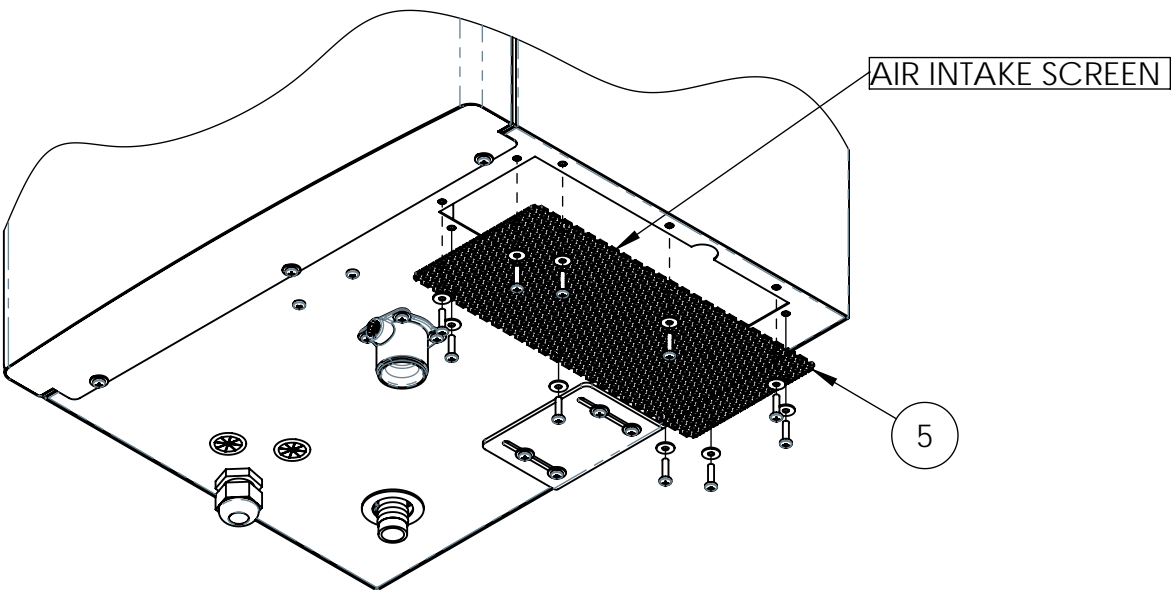

5. Install the supplied bottom air intake screen with the (10) M4 x 0.7 x 16mm screws & washers.